

Product Brochure For C0645

4MT Live Centre Set - Interchangeable Centring Tips

Taiwanese Precision Quality

On Sale

| Ex GST | Inc GST |
|---------------------|---------------------|
| \$270.00 | \$310.50 |
| \$214.78 | \$247.00 |



| | |
|-----------------------------|-------|
| ORDER CODE: | C0645 |
| Taper (MT): | 4MT |
| Maximum Speed (rpm): | 3000 |
| Maximum Load Capacity (kg): | 600 |
| ? Angle: | 60 |
| A: | 23 |
| B: | 51 |
| C: | 108 |
| D: | 47 |
| D1: | 32 |
| L: | 182 |
| Nett Weight (kg): | 1.65 |

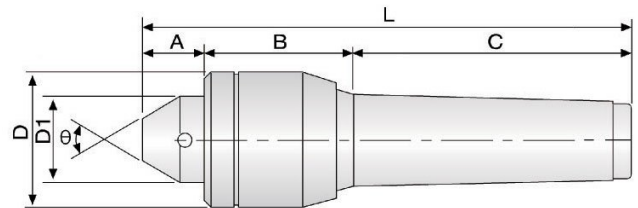

Description

Toolmaster live centre sets are fitted with needle thrust and ball bearings suitable for medium to high speed lathes with heavy loads. The shaft is made from alloy steel heat treated to HRC 60° providing high rigidity and high durability.

Features

- Maximum Speed: 3000rpm @ 180kg
- Maximum Load: 600kg @ 70rpm
- Hardened to HRC 60°
- Made from alloy steel
- Assembled with thrust, needle & ball bearings
- 7 x interchangeable centre tips

Includes

- Interchangeable centre tips:
- 2 x Standard - Ø12.6mm
- 1 x Extended point - Ø6mm
- 1 x Extended point - Ø8mm
- 1 x Extended point - Ø10mm
- 1 x Female cone - Ø6mm
- 1 x Pipe - Ø11 ~ Ø32mm

Product Brochure For C0645

Specific Features

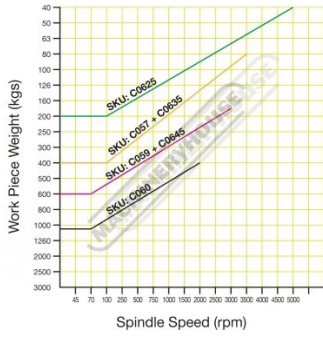

Work Piece Load Graph



Tips



Live Centre



Live Centre Side View



Live Centre Rear View



Set Shown With Tips