

Product Brochure For C836

20 x 100 x ER16 Collet Chuck - Straight

Ø1-Ø10mm Range

On Sale

| Ex GST | Inc GST |
|---------------------|---------------------|
| \$122.00 | \$140.30 |
| \$98.26 | \$113.00 |



| | |
|---------------------------|-----------------|
| ORDER CODE: | C836 |
| MODEL: | 20 x 100 x ER16 |
| Shoulder Type (Yes / No): | Yes |
| D (mm): | 28 |
| D1 (mm): | 20 |
| L (mm): | 30 |
| L1 (mm): | 100 |
| Nett Weight (kg): | 0.3 |

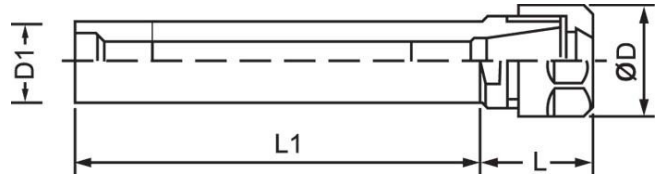

Description

Toolmaster Straight shanked ER collet chucks are suitable for applications such as turret work or can be used as an extension when a long reach is required

Note: Spanner not included

Features

- Precision ground
- Clamping flat

Product Brochure For C836

Recommended Accessories

C840

ER16 Collet Chuck Wrench

C116

Collet Nut ER16

