

Product Brochure For M542

Face Mill Arbor - NT30 - FMB27-20



**On Sale**

Ex GST

**\$74.00**

**\$58.26**

Inc GST

**\$85.10**

**\$67.00**

ORDER CODE:	M542
MODEL:	NT30 - FMB27-20
Draw Bar (mm / inch):	12mm
D (mm):	27
H (mm):	20
K (mm):	7
C (mm):	54
L (mm):	20
Nett Weight (kg):	1.05

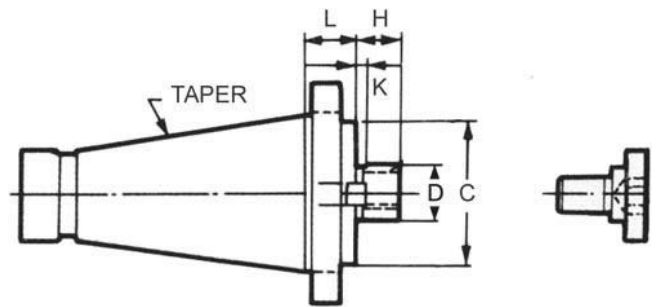

**Features**

- Material: SCM-21
- Hardness: HRC 50° - 55°
- Squareness of mounting surface: Less than 0.0002" (0.005mm)
- Deflection in shaft and taper: Less than 0.0002" (0.005mm)

Product Brochure For M542

---

**Recommended Accessories**

M511

Face Mill 90° - Positive Rake

M512

Face Mill 90° - Positive Rake

M517

Face Mill 45° - Super High-Rake

