

Product Brochure For M554

Face Mill Arbor - NT40 - FMB32-20

**On Sale**

<b>Ex GST</b>	<b>Inc GST</b>
<b>\$110.00</b>	<b>\$126.50</b>
<b>\$86.96</b>	<b>\$100.00</b>



ORDER CODE:	M554
MODEL:	NT40 - FMB32-20
Draw Bar (mm / inch):	16mm
D (mm):	32
H (mm):	21
K (mm):	7
C (mm):	73
L (mm):	20
Nett Weight (kg):	2.40

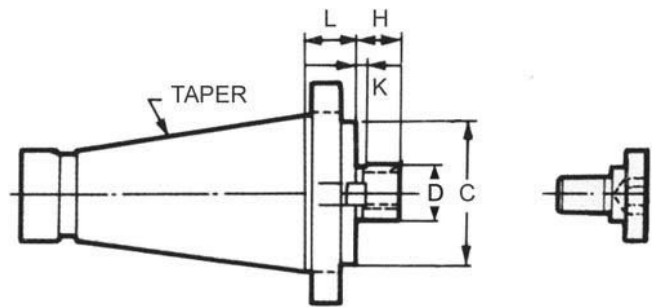

**Features**

- Material: SCM-21
- Hardness: HRC 50° - 55°
- Squareness of mounting surface: Less than 0.0002" (0.005mm)
- Deflection in shaft and taper: Less than 0.0002" (0.005mm)

## Product Brochure For M554

---

### Recommended Accessories

M513

Face Mill 90° - Positive Rake

M518

Face Mill 45° - Super High-Rake

