

Product Brochure For Q245

Inside Caliper Gauge - 33-245

30-50mm/1.2-2.0"

On Sale

Ex GST	Inc GST
\$392.00	\$450.80
\$312.17	\$359.00

ORDER CODE:	Q245
Range:	30 - 50mm / 1.2 - 2.0"
Graduations:	0.01mm / 0.0005"
L (mm):	80
S (mm):	3
H (mm):	8.5

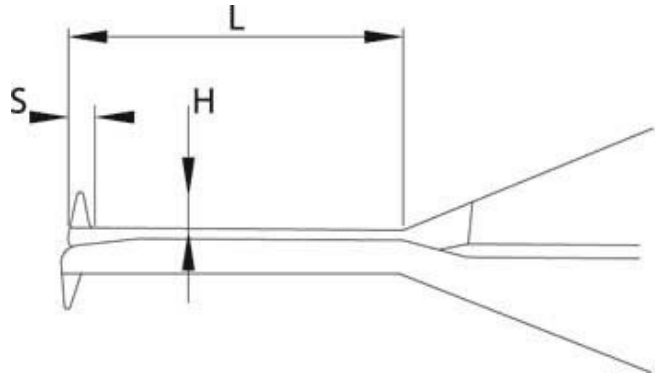

Description

Electronic inside caliper gauges are suited to measuring bores, internal grooves and other hard to reach internal dimensions

Features

- Digital and analogue display on LCD
- Function include Power, Absolute & Incremental
- Metric/Imperial conversion
- Remembers the data of Max. and Min or hold data
- Direct RS232 Output (Uses cable 40-401)
- Auto power off
- Accuracy 0.03mm
- Tolerance set

Includes

- Includes CR2032 battery

Product Brochure For Q245

Specific Features



Insert