

Product Brochure For R101

Multi Pallet Robotic CNC Machine Tending - CUBEBOX

5 Draw Pallet system with customisable draw inlays for workpiece part management
6 axis FANUC Industrial Robot with 25kg Payload

On Sale

Ex GST

Inc GST

~~\$170,190.00~~ ~~\$195,718.50~~

\$169,000.00 **\$194,350.00**



Robot Model:	FANUC M20iD25
Robot Controlled Axes:	6
Robot Capacity (Kgs):	25
Robot Reach (Max) (mm):	1831
Workpiece Draw Size (mm):	800 x 600
Workpiece Draw QTY:	5
Air Consumption (L/Min):	>80
Voltage (V):	415
Electrical Power (kW):	4
Max Current (Amps):	10
Weight (Total) (Kgs):	1500
Robot Cell Dimensions (mm):	2358 x 1495



Description

CubeBOX CNC automation system by Tezmaksan Robot Technologies is a revolutionary robotic automation solution designed to enhance manufacturing processes and reduce operator involvement in machine tending.

With its ability to work non-stop, cost-effectiveness, and flexibility, the CubeBOX system empowers manufacturers to increase productivity, reduce downtime, and stay competitive in the ever-evolving industrial automated landscape.

Let's explore the benefits of CubeBOX in more detail:

1. Continuous operation and efficiency

The core advantage of the CubeBOX system lies in its ability to work non-stop. Ensuring uninterrupted production even during night shifts, this continuous operation leads to a remarkable 50 per cent increase in night shift efficiency compared to traditional setups that rely heavily on manual labour for CNC machine tending. Manufacturers can now maximize their production output, resulting in higher productivity and reduced lead times

2. Easy Setup

Traditionally, the setup of robot peripherals in a system required expert knowledge of robot programming, prolonged changeover times and dependency on skilled personnel. The CubeBOX system changes this paradigm with its user-friendly interface that allows operators to exchange parts effortlessly without any prior knowledge of robot programming. Fast loading and unloading of the workpieces, enhances flexibility and agility in the production process, enabling quick adaptation to changing production requirements.

3. Hassle free robot programming with RoboCAM

The foundation of all CubeBOX systems is RoboCAM, the intelligent automation software also developed by Tezmaksan. By simply uploading product layout drawings, RoboCAM translates them into a robot-friendly language, enabling seamless communication and execution of tasks eliminating the need for prior robot programming expertise.

4. Flexible structure and mobility

The CubeBOX system boasts a flexible structure that enables easy transportation between different machines within the factory. This mobility ensures optimal utilisation of the system across various workstations, eliminating the need for separate robotic setups for each machine. (additional interface required for each machine)

Features

- Cubebox Blues DR (Draw System)
- 6 axis FANUC industrial robot with 25kg payload
- Portable cell can be moved between machines (fork lift or slinging required)

Product Brochure For R101

- 5 Drawer stacker for workpiece layout (Draws 600 x 800mm)
- Safety light curtains on operator load side.
- Schunk dual gripper system, (1 piece for loading & 1 piece for unloading)
- Suitable for round, hexagonal, cast or pressed workpieces
- Clamping surface cleaning with air blow nozzle
- SICK 2D Laser safety scanner
- 3-Colour industrial signal tower
- RoboCAM Smart automation software
- Easy and quick set-up
- Suitable for tending up to 2 CNC machines (additional interface required)
- CE Regulation
- Suitable for CNC Lathes or Machining centers

Includes

- Share your work piece details with us and we will design and customise the systems draw inlays and grippers to minimise any additional setup between multiple work piece changes.
- Robot software options: Soft-Float, Singularity Avoidance, Collision Guard, Remote I-pendant, Integrated PMC

Optional Accessories

- CNC Door Automation
- Work Piece Turnover Stations
- Gripper Exchange Stations
- Universal intermediate jaws, allows fast tool-free and reliable adjustment of top jaws at the gripper
- Robot and CNC communication for additional CNC Machines

Specific Features



Operator Load side



FANUC industrial robot

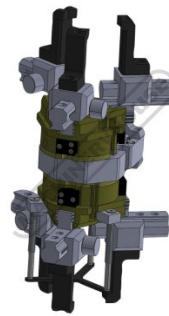

Custom designed grippers



Material Loading



Material Loading



Shown Tending 2 Machines