

Product Brochure For S7455

Angle Iron Lateral Side Guide Roll Support Set - PK35F-GUIDE

Maximum Angle Iron Capacity - 50 x 50 x 6mm

Suits PK-35F, HPK-45, HPK-50 Section Rolling Machine

On Sale - Back In Stock Soon

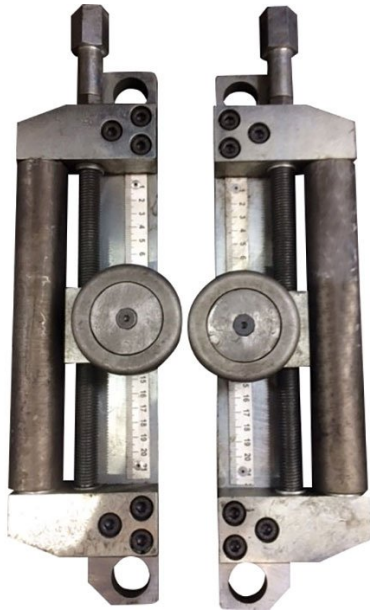

Ex GST	Inc GST
\$2,014.00	\$2,316.10
\$1,940.00	\$2,231.00

ORDER CODE:	S7455
MODEL:	PK35F-GUIDE
Rolls (Type):	~
Tube Roll Size Metric / Imperial - (OD) (mm / Inch):	~
Pipe Roll Size Metric / Imperial - (NB) (Inch / mm):	~
Bore Size (mm):	~
Suits Rolling Machines:	PK-35F



Description

These optional guides roll supports (left & right) are used on the PK-35F, HPK-45 & HPK-50 section rolling machines for when you need to roll angle iron leg inwards or leg outwards

Features

- Maximum Angle Iron Capacity - 50 x 50 x 6mm
- Please Note:
- PK-35F, HPK-45, HPK-50 Section Rolling Machines will also require optional Angle Roll Dies to work in conjunction with these lateral side guide roll supports

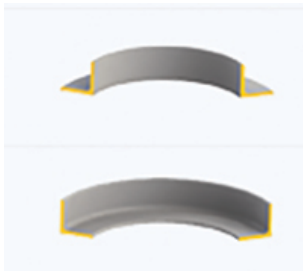

Product Brochure For S7455

Specific Features



Shown On Machine



Pair Shown On Machine

Recommended Accessories

S745

Section & Pipe Rolling Machine

S745H

Angle Iron Roll Dies

S741H

Angle Iron Roll Dies

