

Product Brochure For S989S

35° Top Punch Pressbrake Tooling - Segmented - TP35-116.800S

116mm High x 800mm Long, Divided in Segments - 10, 15, 20, 40, 50, 100, 200, 365mm
Suits MetalMaster, Amada & European Pressbrakes

On Sale

Ex GST	Inc GST
\$770.00	\$885.50
\$649.57	\$747.00

Order Code:	S989S
Model:	TP35-116.800S
Type:	35° Top Punch
Size (mm):	116 x 800 In Segments Of & 10,20,40,50,100,200,365



Description

Precision Pressbrake Punch made from chromium-molybdenum high strength steel and heat treated for long term durability.

Nose Angle - 35 Degrees
Nose Radius - 1.5mm
Total Height - 116mm
Shoulder height - 86mm
Max. Tonnage - 700kN/m
Length - 800mm divided into the following segments: 10, 15, 20, 40, 50, 100, 200, 365mm

Suits MetalMaster, Amada & European Pressbrakes

Product Brochure For S989S

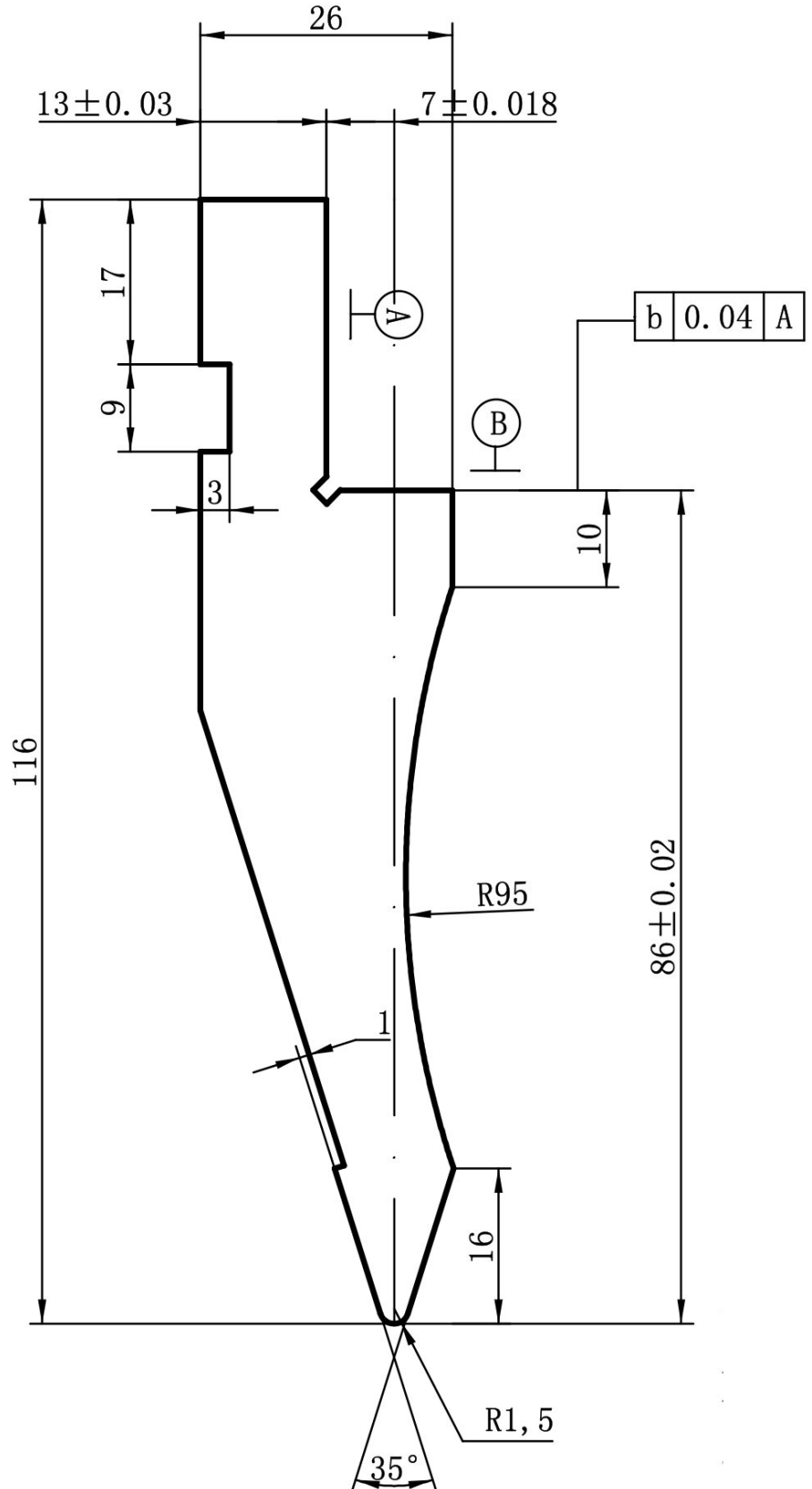

Product Brochure For S989S

Specific Features



Profile



Side View